

Installation Instruction for Use

Deluxe Dumbbell Rack

Please read this instruction before installing and using the product

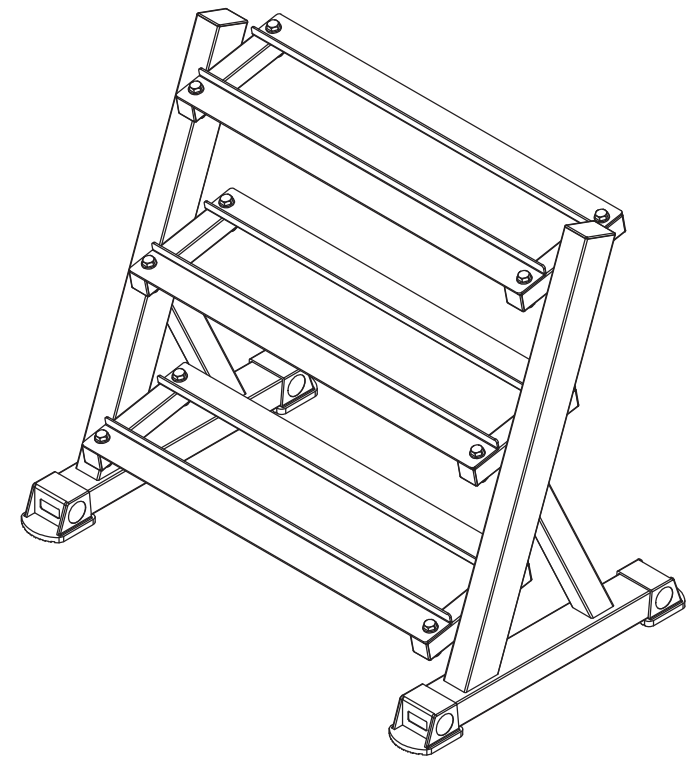

Explosive Diagram

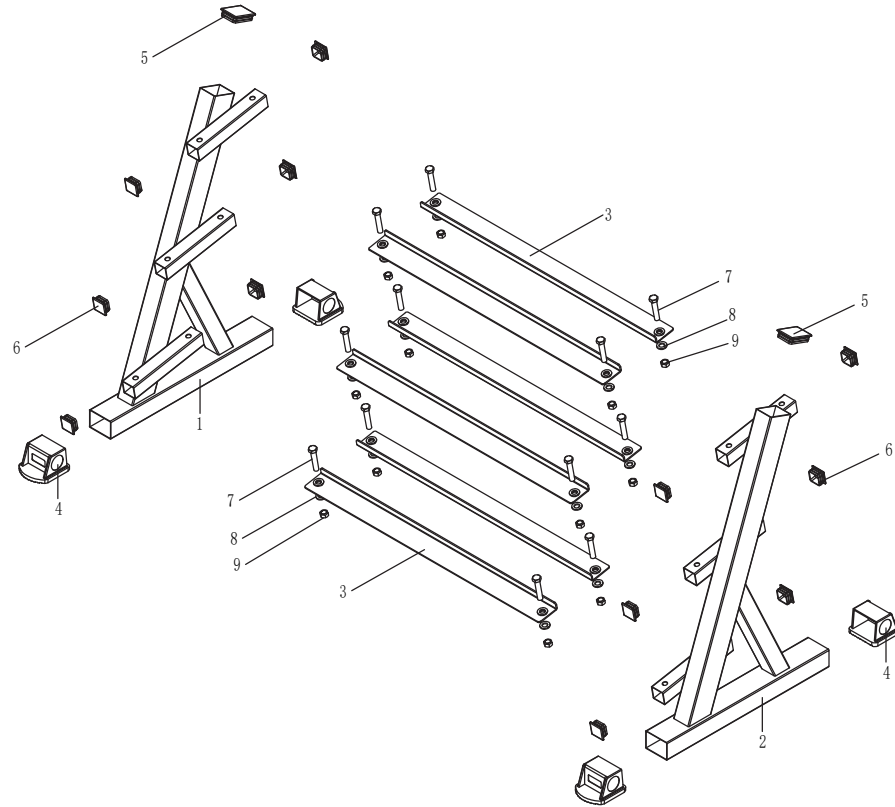

Component List

No.	Name and Strength	Quantity
1	<u>Left side weldment</u>	1
2	<u>Right side weldment</u>	1
3	Mounting plate	6
4	Outside foot cover	4
5	Circle tube internal blocking head	2
6	square tube internal blocking head	12
7	Hex bolt (M12*60)	12
8	flat cushion D12	24
9	Anti-loose nut M12	12

Assembly Instructions

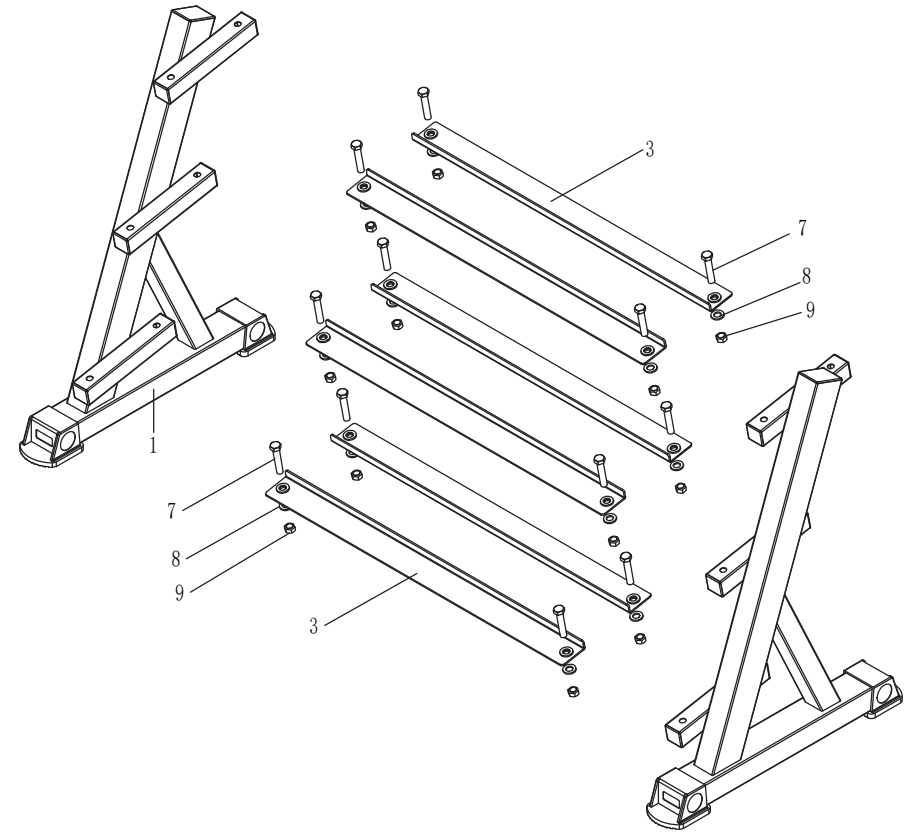

Put component 1 and 2 according to the figure, and use hex bolts M12*60 (7), flat cushion D12 (8) and anti-loose nut M12 (9) to connect mounting plate (3) with (1) (2) as shown in the figure.